

G01

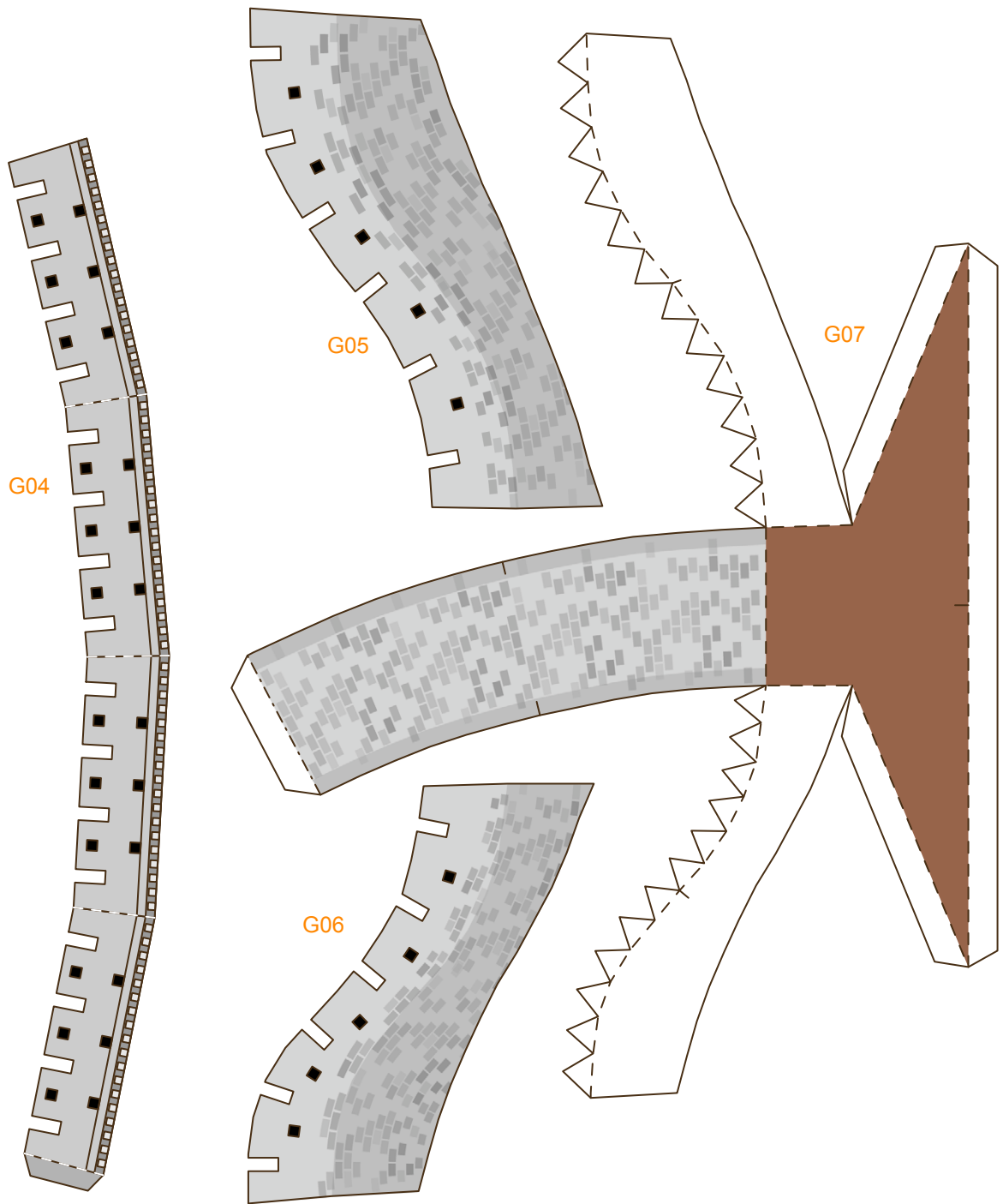

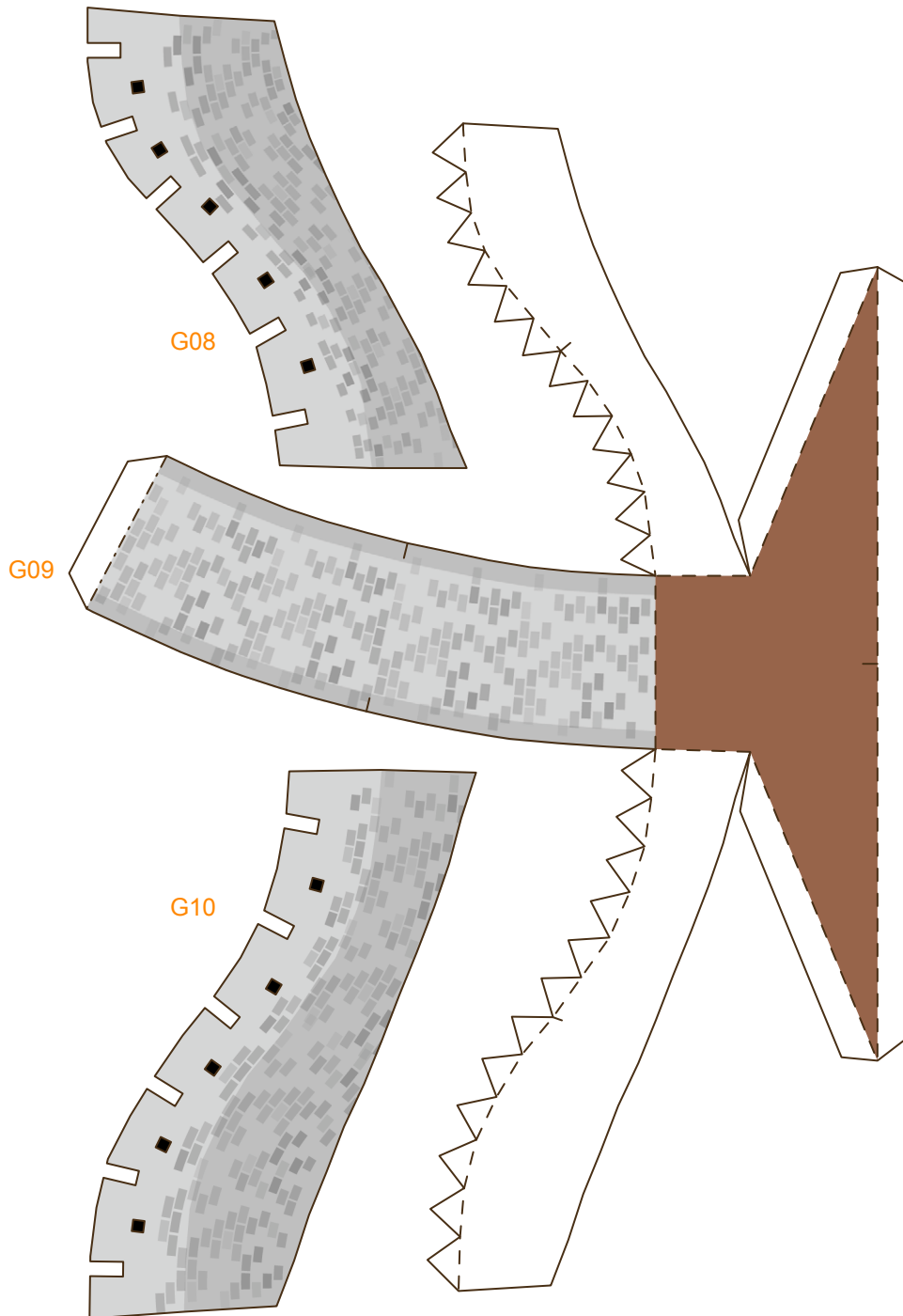

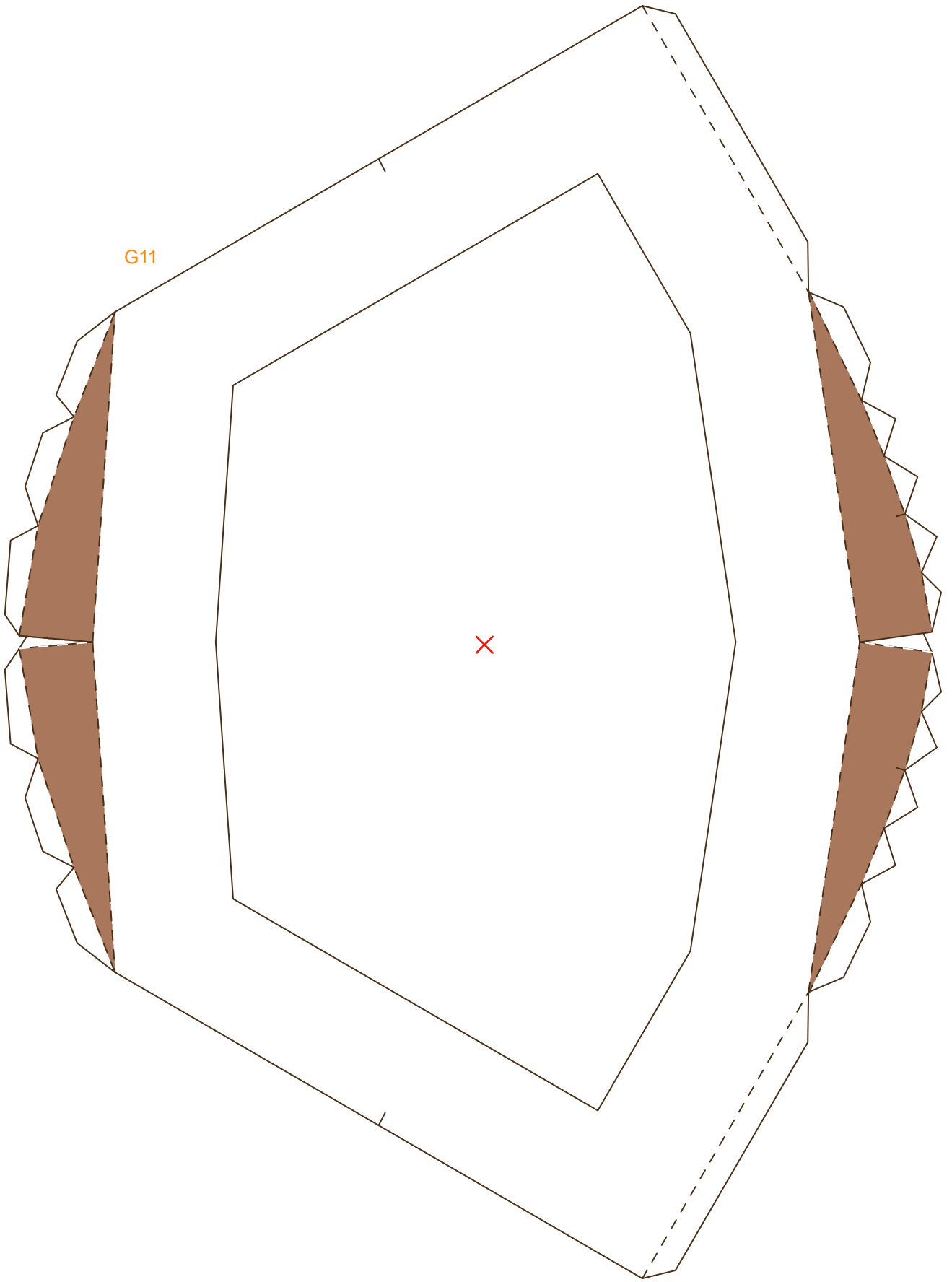



組合說明

--- 山折線

--- 谷折線

✕ 切除部分

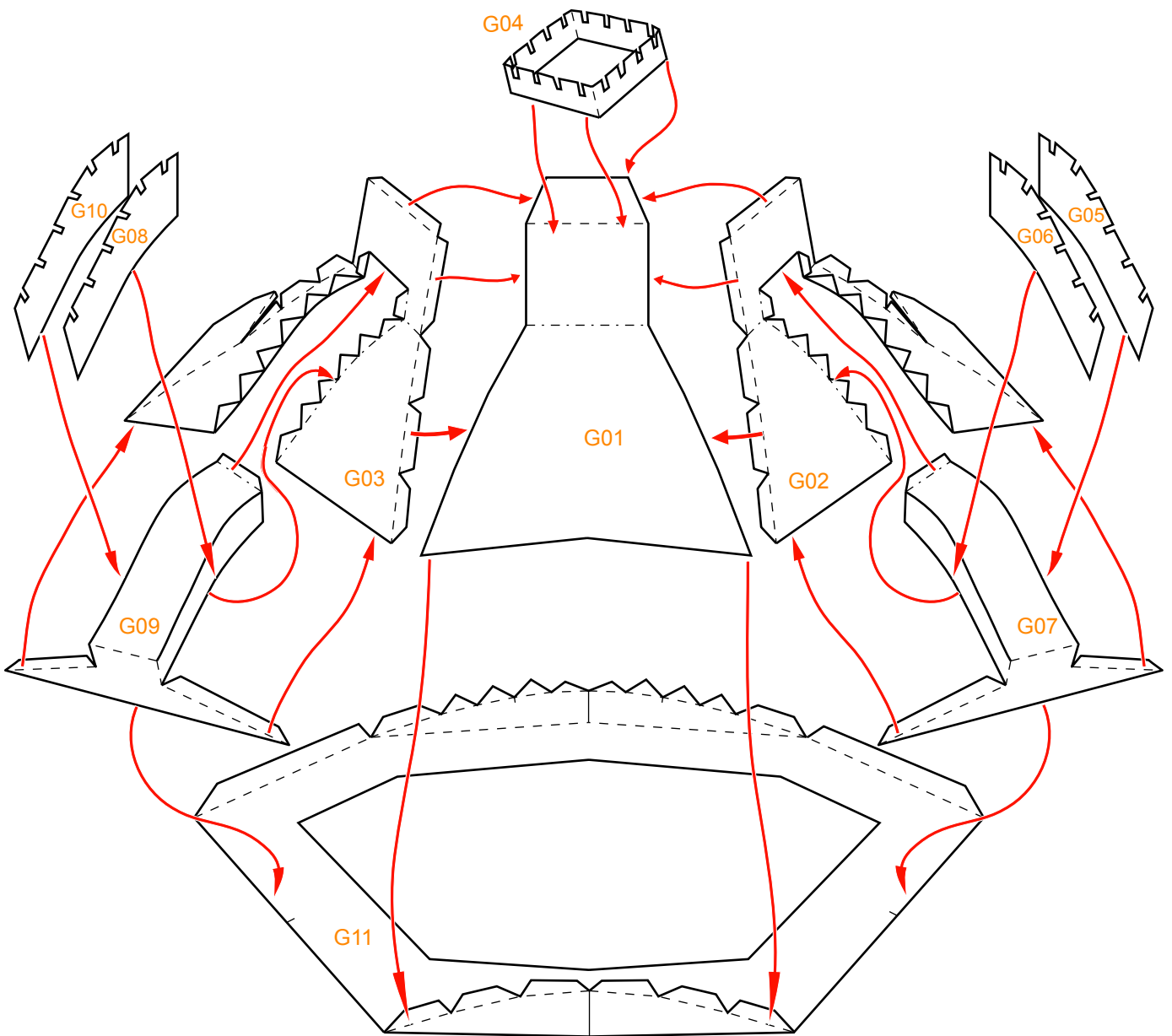
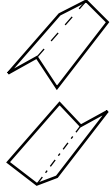

基本步驟

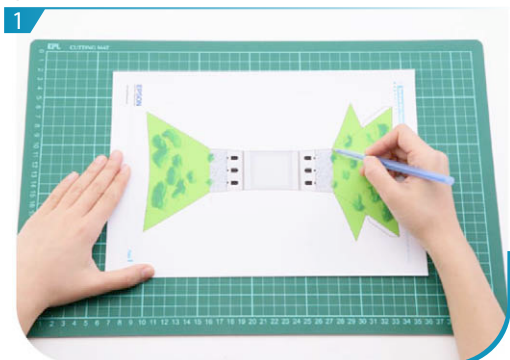

用沒有墨水的原子筆或鐵筆劃一下摺線。

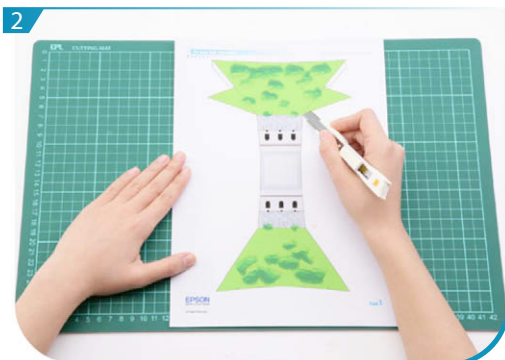

沿線剪出所有組件。為免混淆，可先在組件背面劃上記號。

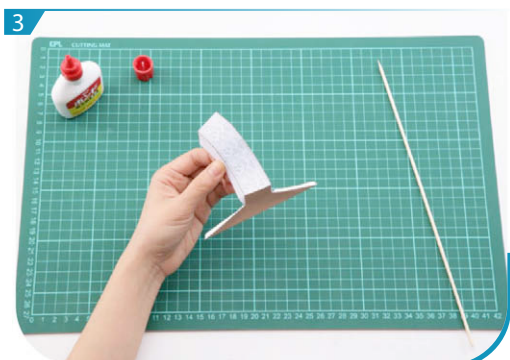

將G07摺疊貼好。



將G07及G02貼合。

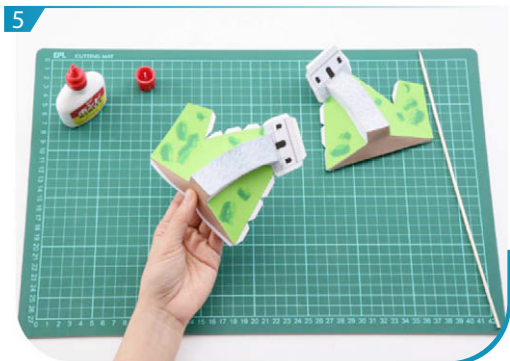

將G09摺疊貼好，再貼上G03。



將以上組件與G01貼合。

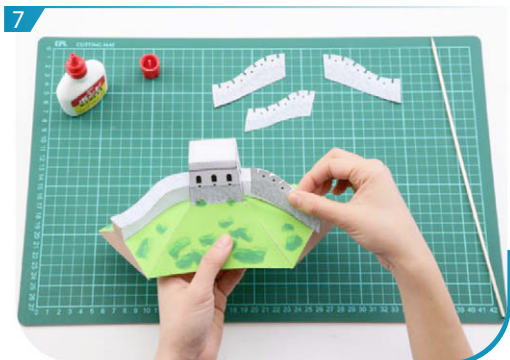

將G05、G06、G07及G08按組合說明貼好。

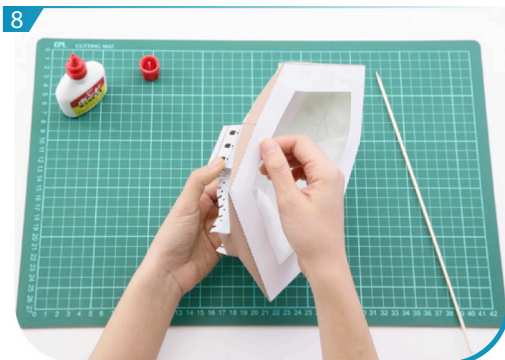

將G11貼於底部，形成底台。

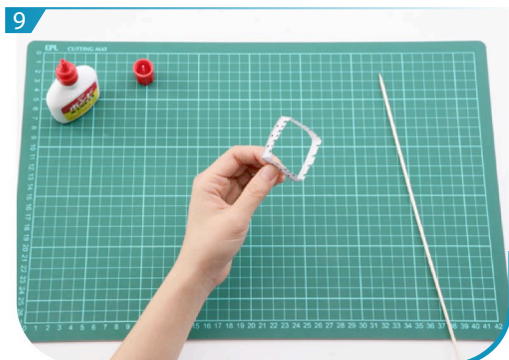

將G04摺疊貼好。

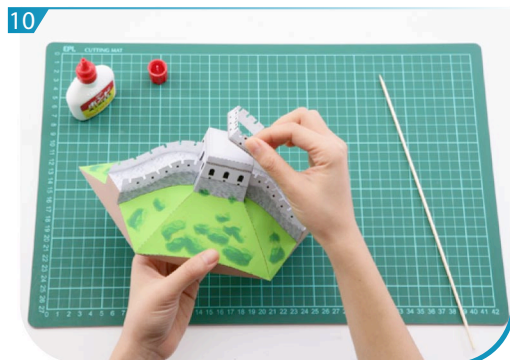

將G04貼於長城頂部。



重複以上步驟 1-10，即成連綿不斷的萬里長城。