

### 組合說明

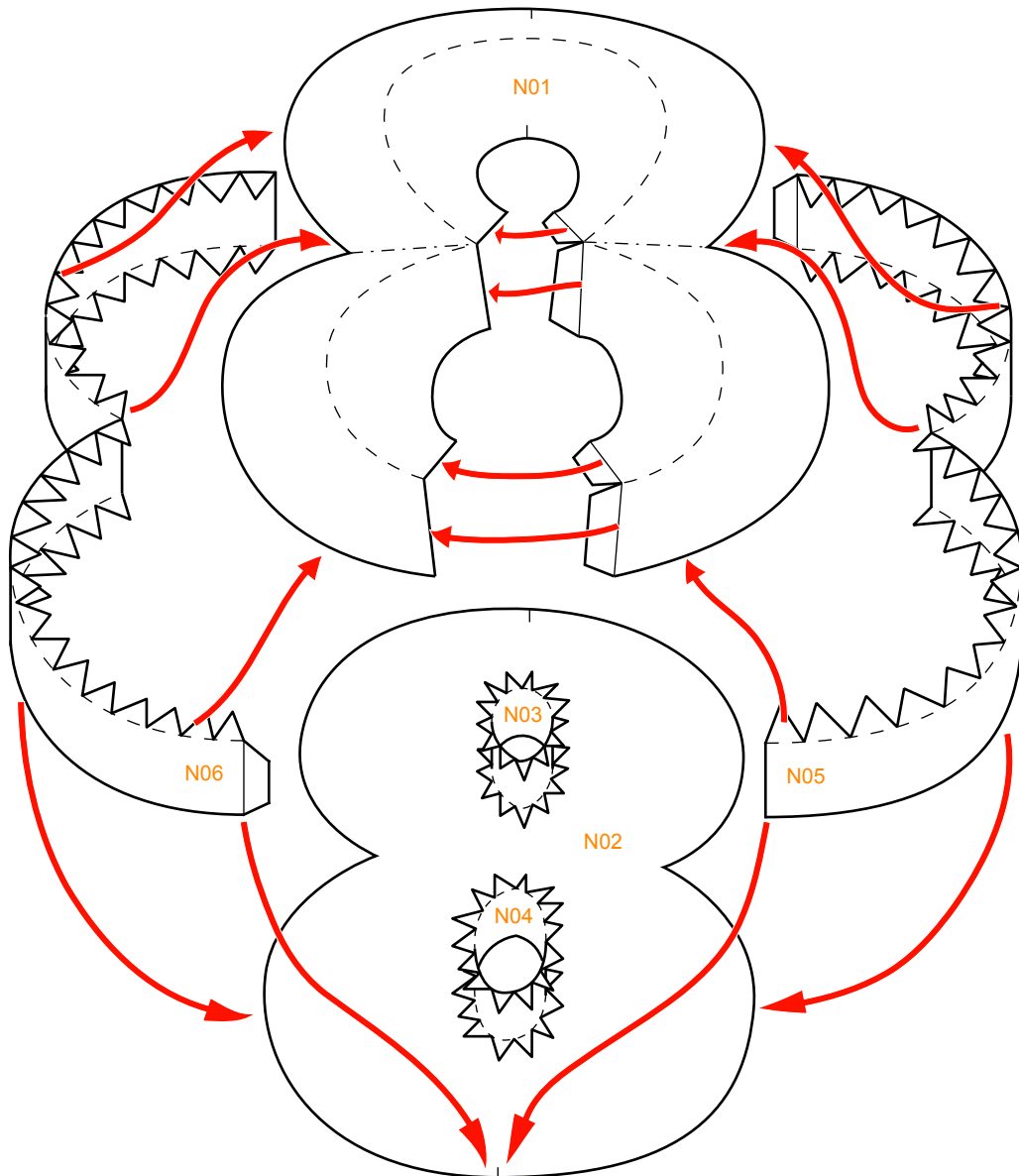

製作步驟

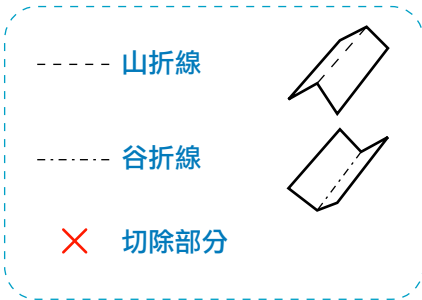
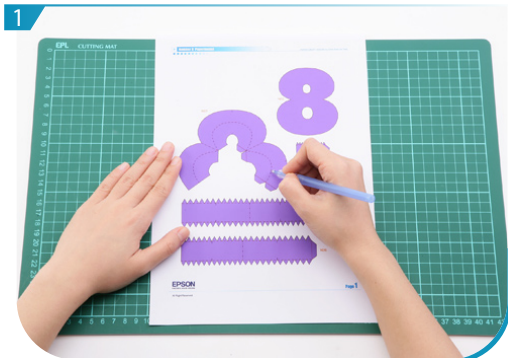

1 用沒有墨水的原子筆或鐵筆劃一下摺線。



2 沿線剪出所有組件。為免混淆，可先在組件背面劃上記號。

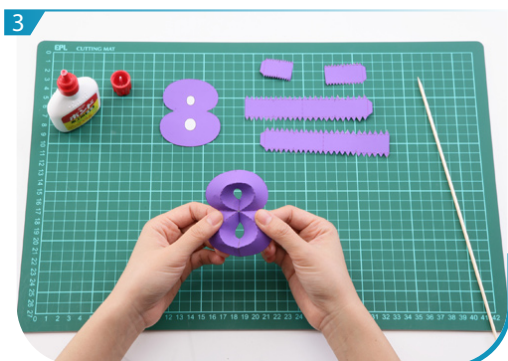

3 將N01摺疊貼好。

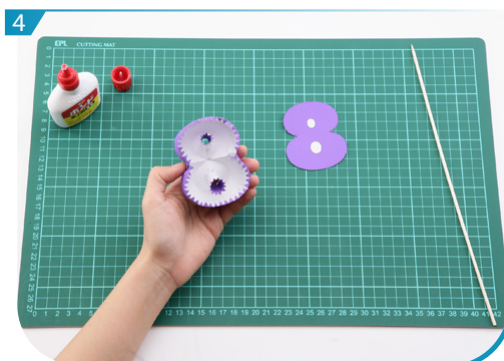

4 將N01, N03, N04, N05及N06按組合說明貼好。

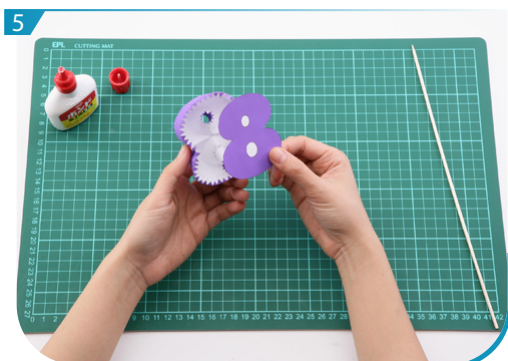

5 再加上N02，即成立體數目字“8”。