

Epson RC+[®] Express Industrial Automation Software

Robot Solutions

Software



No-code, easy-to-use robot teaching environment.

Get up and running fast — with a simple, visual-based teaching environment built for new users with little to no programming experience

Easy to use — features a simple-to-follow, block-style format with the power and flexibility of a scripted-text programming language

Simple to navigate — clear, intuitive, visual user interface makes it easy to learn and manage key functions like jogging, gripper control and motion

Common application templates included — quickly create common pick-and-place, palletizing and depalletizing applications with ready-to-use template programs and tutorials

Develop applications with low risk — built-in 3D simulator lets you conveniently program and fine-tune applications before hardware setup; run robot at low power and speed in rehearsal mode when testing new programs

Quick setup — Epson[®] proprietary Focus Assist technology provides quick-teach tools with auto-generated fields for fast application setup

Extended capabilities — in addition to advanced SPEL+ command functionality, experienced users can create more complex solutions using the optional Epson RC+ Project Link

Automation simplified — works with hundreds of Epson SCARA and 6-axis robots, from the All-in-One Series to the highest-performance GX- and C-Series

Tablet-based Windows[®] OS environment — compatible with touchscreen devices, in addition to PCs, to easily create robot applications

Low total cost of ownership — Epson RC+ Express is included with robot purchases and no recurring licensing fees

Specifications	
Compatible Robots/ Controllers	T-Series All-in-One SCARA Robots (Built-in Controller): T3 and T6 T-B Series All-in-One SCARA Robots (Built-in Controller): T3B and T6B LSB-Series SCARA Robots (RC90B): LS3B, LS6B, LS10B, LS20B G-Series SCARA Robots (RC700A): G1, G3, G6, G10, G20 GX-Series SCARA Robots (RC700D): GX4 and GX8 VT-Series All-in-One 6-Axis Robot (Built-in Controller): VT6L C-Series 6-Axis Robot (RC700A): C4, C8, C12
Controller Firmware	RC700A, RC90B: 7.5.1.0 RC700D: 7.5.1.2 All-in-One T- and VT-Series: 7.5.51.0 All-in-One TB-Series: 7.5.51.1
Trial Software	Free download available at www.epson.com/rc+expresstrial
Application Type	Pick and Place, Material Handling, Palletizing and Depalletizing <small>(Epson RC+ 7.0 available for complex applications. Please contact Epson for your application inquiries.)</small>
Teaching Blocks	Motion Commands, Gripper Commands, Logic Commands, Pallet Commands, Dialog Commands
Epson RC+ Project Link	Optional software allows connection to Epson RC+ programs to enable Vision Guide and other functions available in RC+
Features	Block-style visual programming (no code required), Focus Assist for rapid application configuration, Built-in Templates (Pick and Place, Palletizing, Depalletizing), Robot Health Monitoring, Source Level Debugger, HTML Help, Content Help, Robot Controller Status Bar, Project Management
Communication	USB or Ethernet
User-Provided Tablet Requirements	OS: Windows 10 Pro (64-bit) CPU: Core i5 or higher RAM: 2GB HDD: 4GB Display: 1280 x 760 or bigger

Support

Customer Service
(562) 290-5920
service@robots.epson.com

Applications Support
(562) 290-5930
applications@robots.epson.com

Sales Inquiries
(562) 290-5997
info@robots.epson.com

Block-Style Visual Programming

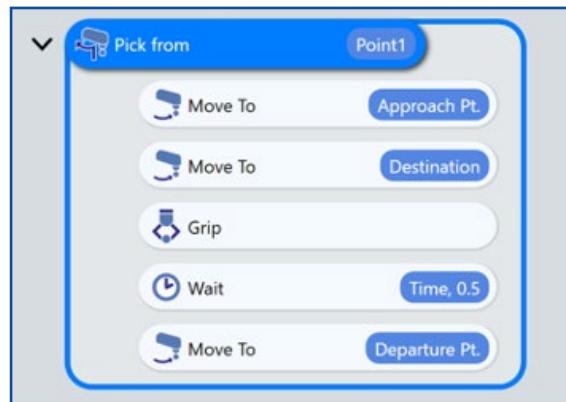

Quickly and Easily Configure Pallets

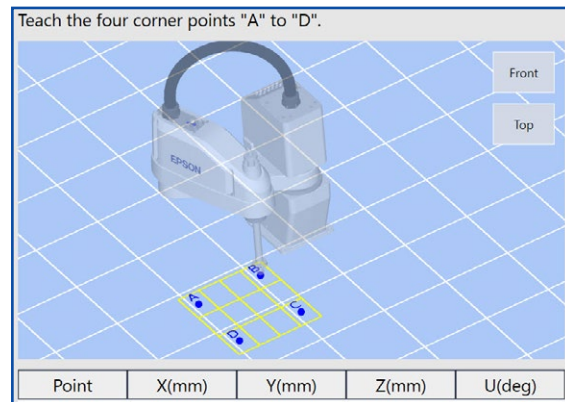

Better Products for a Better Future[™]
eco.epson.com

Epson America, Inc.
3131 Katella Ave., Los Alamitos, CA 90720



Epson Canada Limited
185 Renfrew Drive, Markham, Ontario L3R 6G3



www.epson.com
www.epson.ca

Contact:

Specifications and terms are subject to change without notice. EPSON and Epson RC+ are registered trademarks, EPSON Exceed Your Vision is a registered logomark and Better Products for a Better Future is a trademark of Seiko Epson Corporation. Windows is either a registered trademark or trademark of Microsoft Corporation in the United States and other countries. SmartWay is a registered trademark of the U.S. Environmental Protection Agency. All other product and brand names are trademarks and/or registered trademarks of their respective companies. Epson disclaims any and all rights in these marks. Copyright 2022 Epson America, Inc. CPD-63027 10/22