

EMPOWERING BUSINESSES WITH SCALABLE PROJECTION TECHNOLOGY.

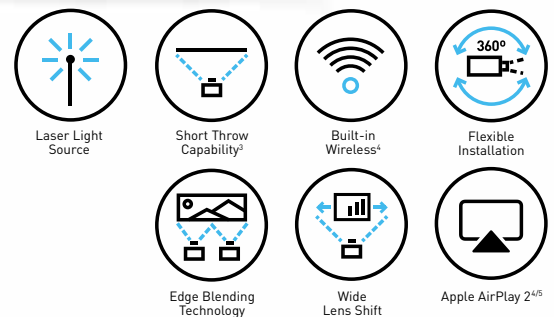

Transform Any Space with Versatile, High-Performance Projectors

The new compact L-Series business range projectors feature 4K Enhancement technology¹ and up to 8,000 lumens² of brightness for vibrant visuals. Designed for efficiency, these projectors offer exceptional flexibility with short throw³ capabilities, making them perfect for art spaces, simulators, and entertainment spaces. The built-in NFC function simplifies setup via the Epson Projector Config app, while features like center-lens placement, 360° installation, and diverse connectivity options provide a high-performance solution for any environment.



Superior Image Quality

Enjoy sharp visuals with up to 8,000 lumens¹ and 4K Enhancement technology¹, ensuring vibrant images even in bright environments.

Flexible Installation

The compact design, with 360° rotation and a built-in NFC function, allows for easy stacking and offers a variety of installation options.

Fast and Easy Connectivity

Enjoy convenient projection with wireless connections offering faster speeds, eliminating the hassle of cables.

¹Source: Futuresource Quarterly Market Insight Report, FY2024. ² For selected models. ³ For EB-L890U. ⁴ For EB-L690SE, EB-L790SE and EB-L690SU.

⁵ Except EB-L690SE. ⁶ AirPlay 2 is a wireless media streaming protocol developed by Apple.



Delivers bright, clear visuals even in bright environments
and across large surfaces.

4K Enhancement Technology

For selected models

A screen resolution equivalent to 4K is achieved by "pixel shifting," in which each pixel of the input video is shifted by 0.5 pixels vertically and horizontally to increase the resolution. The result is crisp, high-definition images.

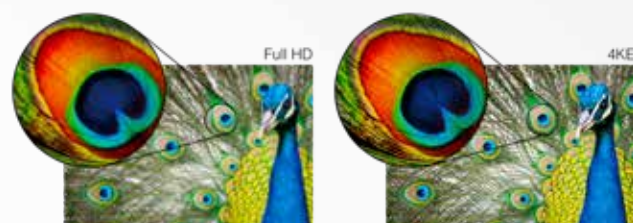
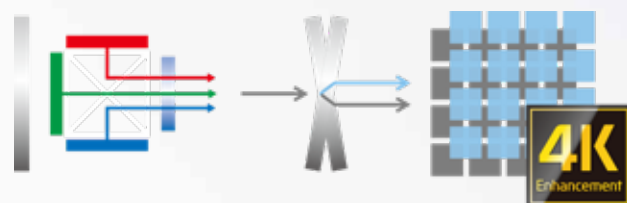

Deliver up to 4.6 million pixels with 4K Enhancement Technology.

Enhanced HDMI 4K Bandwidth

The HDMI 4K signal bandwidth has been expanded from 10.2Gbps to 18Gbps, supporting up to 3840×2160 at 60Hz RGB 8bit. It also supports 4K60Hz HDR formats, delivering vibrant, high-quality visuals.



Excellent Image Quality

Epson's 3LCD technology produces bright, vivid colours and delivers highly visible images. The laser light source provides more natural-looking whites and clearer images.

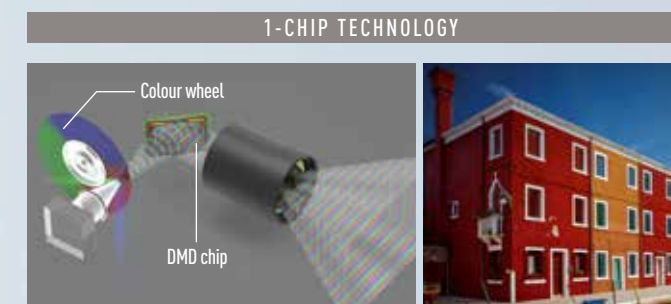
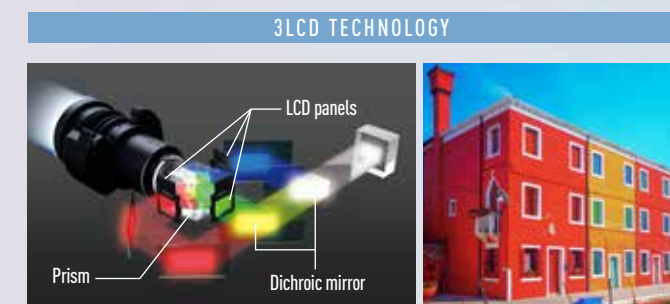

Sharp Images with Extensive Quality Adjustment Features

Detail enhancement function ensures exceptional visibility, delivering the perfect balance between images and text.



Function OFF



Function ON

Scene Adaptive Gamma Correction

Epson projectors feature innovative Scene Adaptive Gamma Correction, which automatically adjusts image quality based on the content. This frame-by-frame optimisation enhances contrast, fine-tuning blacks in dark scenes and whites in bright scenes, delivering natural, lifelike visuals.



Corner Focus Adjustment Function

*For EB-L790SE, L690SE, L690SU

The short-throw models* feature a corner focus adjustment function that lets you fine-tune the focus at the edges of the screen, ensuring uniform image quality. Like the focus and zoom, it can be manually adjusted by rotating the ring.





Adaptable Setup

The compact and lightweight design allows for easy installation in confined spaces, offering flexible placement options for any environment or setup.



Enhanced Connectivity with HDMI OUT Terminal

The HDMI OUT terminal supports daisy-chaining to sub-displays, allowing screen duplication without a switcher.

Effortless Setup with NFC

NFC functionality allows seamless communication with smart devices even when the projector is powered off. This feature can be easily configured and monitored using the Epson Projector Config Tool on a smart device. It enables initial setup to be performed at the warehouse before transportation, reducing the time required for kitting and streamlining the installation process when deploying multiple projectors.

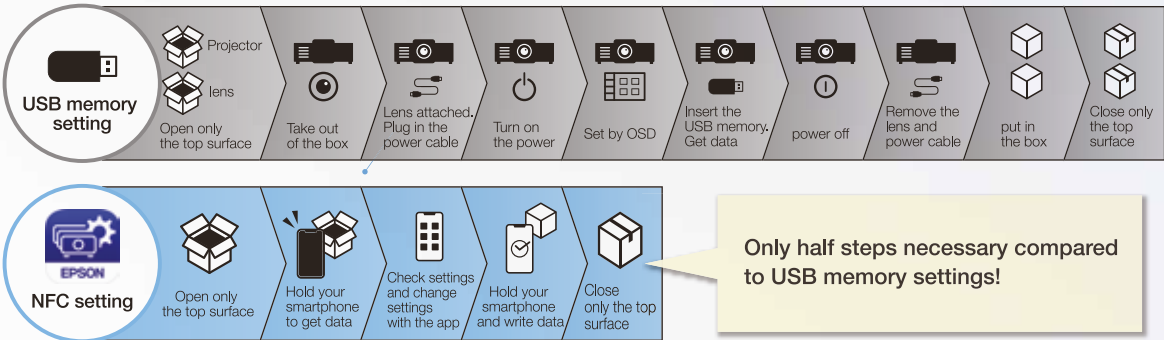

The short-throw line-up opens up endless possibilities for diverse applications and setups, from immersive simulations to interactive displays, across industries like education, entertainment, and the corporate sector.



Strengthening Our Lineup of Short-throw Models

Our short-throw projector lineup* offers even more versatile applications, making it possible to achieve exceptional performance in a wide range of environments.

Comparison of Throw Ratios

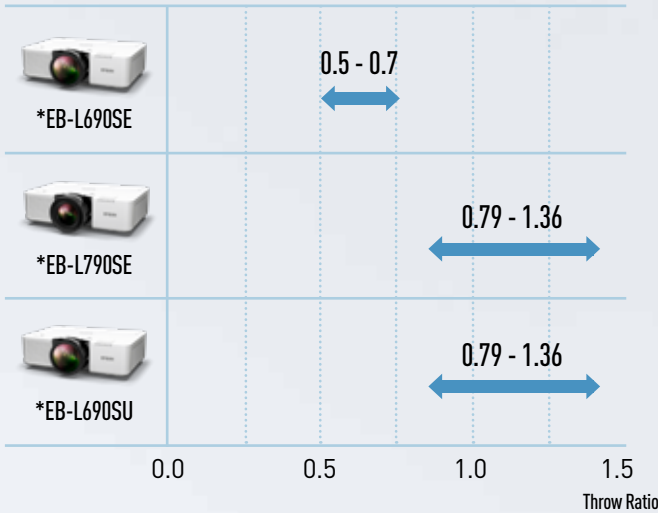

Zoom Lens with a Throw Ratio Starting from 0.5

Featuring a zoom lens with a throw ratio starting from 0.5, these projectors offer flexible installation options. They support ceiling-to-floor projection and allow easy angle adjustments for low ceilings, making them ideal for simulation spaces such as golf simulators.



Short-throw Lens with Optical Zoom Capability

A short-throw lens with optical zoom eliminates image quality loss from electronic zoom, allowing angle adjustments without quality loss.



INSTALLATION FLEXIBILITY

Auto Geometry Correction Function Support

By combining the ELPEC01 external camera with Epson Projector Professional Tool software, the Auto Geometry Correction Function ensures quick and easy setup for multiple projectors. The 4K enhancement* feature further supports geometric correction, enabling high-resolution projection in any environment. Additionally, automatic stacking and blending corrections can be applied to both flat and curved walls.

*For selected models.



Geometry Correction Assist for Blending

Require External Camera

This feature streamlines multi-projector setups by automatically aligning and blending overlapping images, ensuring a seamless, uniform display with minimal manual effort.

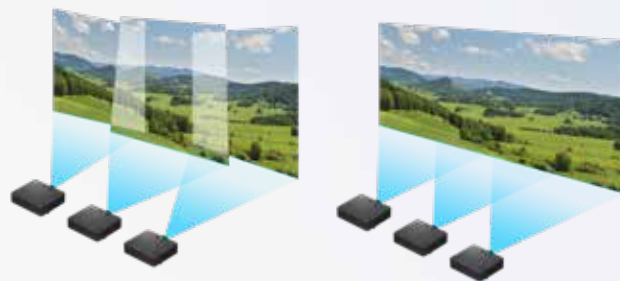

Geometry Correction Assist for Stacking

Require External Camera

Elevate your setup with Stacking Assist via Epson Projector Professional Tool. Easily stack two projectors and use Auto Tiling Assist for edge-blended, supersized images.



Screen Matching

Automatically adjusts colour inconsistencies when using multiple projectors.

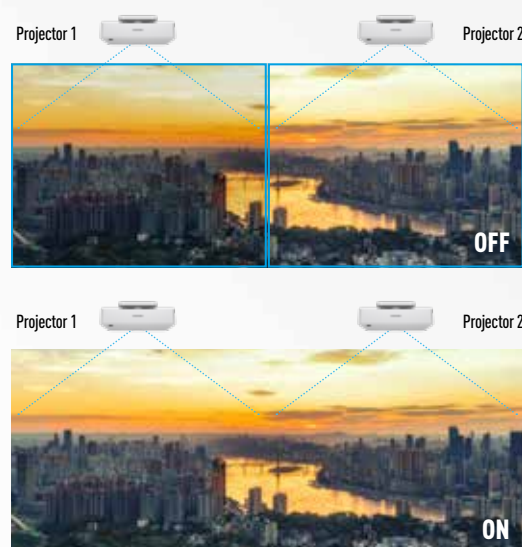

Focus Function

Automatically calibrates the focus at the corners of the projected image upon powering on the projector.



With Corner Focus Adjustments

CONNECTIVITY & RELIABILITY



Wireless Connection with Miracast®

Except For EB-L690SE

Miracast® allows for easy connection of smart devices and laptops to the projector. The L890E series supports Miracast®, with no software installation required. The quick wireless connection ensures a smooth presentation experience and eliminates the need for cumbersome cables.



Disclaimer: Miracast® is a registered trademark of Wi-Fi Alliance®. Please note that laptops and smart devices must also be Miracast®-compatible to use this feature.

Seamless Streaming Made Easy with AirPlay 2

Except For EB-L690SE

This projector features built-in Apple AirPlay 2, making it easy to stream videos, music, photos, and more directly from your iPhone, iPad, or Mac, with synchronized playback across other AirPlay-enabled devices.



Disclaimer: AirPlay 2 is a wireless media streaming protocol developed by Apple.

Experience the Future of Connectivity with Wi-Fi 6

The L890E series supports Wi-Fi 6, providing faster speeds, lower latency, and improved performance in crowded environments. Wi-Fi 6 ensures smooth streaming, seamless video conferencing, and faster downloads.



Supports Epson Projector Management Connected

Streamline daily operations with EPM / EPM Connected support, allowing efficient status monitoring and issue identification. Enjoy reliable monitoring without the need for additional equipment, and easily install in any LAN environment without a PC.



Improved Usability

Designed with a user-friendly interface, it offers easy navigation both on the device and via remote control. Intuitive features and straightforward controls ensure that users can operate it effortlessly, providing a hassle-free experience every time.

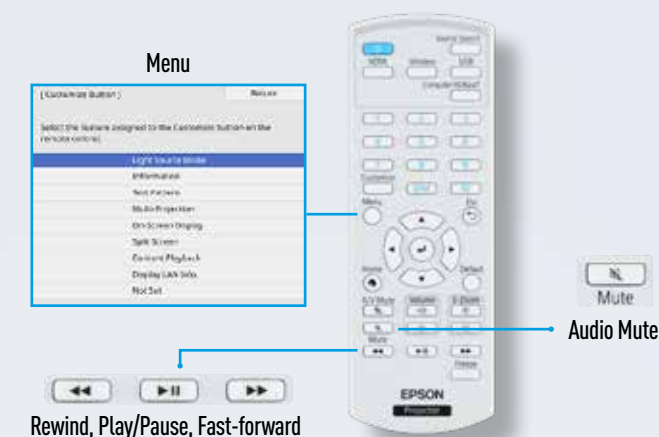

SPECIFICATIONS

MODEL NUMBER		EB-L690E	EB-L890E
SKU Code		V11HB25056	V11HB24056
Projection Technology		RGB liquid crystal shutter projection system (3LCD)	
Specifications of Main Parts			
LCD	Size	0.67" (C2 Fine)	
	Driving Method	Poly-silicon TFT active matrix	
	Pixel Number	2,304,000 dots (1920 x 1200) x 3	
	Native Resolution	WUXGA (4K Enhancement)	
	Aspect Ratio	16:10	
Projection Lens	Pixel Arrangement	Cross stripe	
	Type	Optical Zoom (Manual) / Focus (Manual)	
	F-Number	1.5 – 1.7	
	Focal Length	20.0 – 31.8 mm	
	Zoom Ratio	1.0 - 1.60	
	Throw Ratio	1.35 – 2.20	
	Lens Shift	Vertical: ±50% (Manual) Horizontal: ±20% (Manual)	
Lightsource	Type	Laser Diode	
	Life (Normal / Extended)	20,000 hours / 30,000 hours	
Screen Size (Projected Distance)			
Zoom: Wide		50" – 500" [1.49 – 14.94 m]	
Zoom: Tele		50" – 500" [2.44 - 24.35 m]	
Brightness ^{*1}			
White Light Output (Normal / Eco)		6,500 lm / 4,550 lm	8,000 lm / 5,600 lm
Colour Light Output		6,500 lm	8,000 lm
Light Output (Center) ^{*2}		7,100 lm	8,700 lm
Contrast Ratio			
		Over 5,000,000:1	
Geometric Correction			
Projection Orientation		360° Free	
Vertical / Horizontal Keystone		±30° / ±30°	
Connectivity			
Digital Input	HDMI In	2 (HDCP 2.3)	
	HDBaseT	1 (HDCP 2.3)	
USB Input	USB Type A	2 (Port 1: For PC Free, Document Camera, Firmware Update, Copy OSD Settings, Content Playback, ELPEC01 or 5V/2A Power Supply; Port 2: For PC Free, Document Camera, Firmware Update, Copy OSD Settings, Content Playback, ELPEC01 or 5V/0.9A Power Supply)	
	USB Type B	1 (For Firmware Update, Copy OSD Settings)	
Control I/O	RS-232C	1 (D-Sub 9pin)	
Digital Output	HDMI Out	1 (HDCP 2.3, supports only HDMI1 input)	
Audio Output	Stereo Mini	1	
Network	Wired LAN	RJ45 x 1 (100Mbps)	
	Wireless LAN	Built-in	
Miracast			
Certification		Wi-Fi CERTIFIED Miracast R2	
Supported Codec		H.264 (AVC)	
AirPlay 2			
Supported Codec		H.264(AVC), H.265(HEVC), AV1, VP9, MPEG-2, MPEG-4	
Internal Speaker			
		10 W Monaural	
Wireless Specification (Built-in Wireless LAN)			
Supported Speed		IEEE802.11a/b/g/n/ac/ax	
Supported Mode		Infrastructure, Simple AP (Wi-Fi Direct)	
Supported Security Type		Infrastructure: Open, WPA2 / WPA3-PSK, WPA2 / WPA3-EAP Supported EAP Type: PEAP, EAP-TLS Simple AP (Wi-Fi Direct): WPA2-PSK (AES)	
Operating Temperature			
Single Use		Low Altitude (0 - 2,286m/7,500ft): 0 - 45 °C <32 - 113 °F> High Altitude (Over 2,286m/7,500ft): 0 - 40 °C <32 - 104°F> 20% - 80% Humidity, No Condensation	
Multi-Projection Use		Low Altitude (0 - 2,286m/7,500ft): 0 - 40 °C <32 - 104 °F> High Altitude (Over 2,286m/7,500ft): 0 - 35 °C <32 - 95°F> 20% - 80% Humidity, No Condensation	
Operating Altitude			
		Over 1,500m/4,921ft with High Altitude Mode: 0 - 3,048m (0 -10,000ft)	
Direct Power On / Off			
		Yes	
Start-Up Period			
		12 seconds (Epson Logo); Warm-up Period: 30 seconds	
Quick Start-Up			
		Less than 8 seconds (Display)	
Cool Down Period			
		Instant Off	
Air Filter	Type	Electrostatic Filter	
	Maintenance Cycle ^{*3}	20,000 hours (Normal) / 30,000 hours (Extended)	
Power Supply Voltage			
		100 - 240 V AC ±10%, 50/60 Hz	
Power Consumption (220 - 240V)			
Laser Diode On	Normal	399 W	450 W
	Extended	295 W	330 W
Standby (Normal / Eco)		2.4 W / 0.4 W	
Dimension Excluding Feet (W x D x H)			
		440 x 304 x 122 mm	
Weight			
		Approx. 8.2kg	Approx. 8.5kg
Fan Noise (Normal / Eco)			
		32dB / 25dB	36dB / 26dB

^{*1} Colour brightness (colour light output) and white brightness (white light output) will vary depending on usage conditions. Colour light output measured in accordance with IDMS 15:4; white light output measured in accordance with ISO 21118.
^{*2} This light output value is measured at the centre of the screen as a reference value. There is no official standard for light output (Centre) measurements and this measurement is made based on the method set by Epson.
^{*3} When used in the general office environment (the amount of floating dust: 0.04 - 0.2 mg/m3). Based on the Epson's in-house test results.

Supplied Accessories

Power Cable: 3m, 3 wire
Remote Control: Yes, with Alkaline AA Battery
User Guide

Optional Accessories

Cable Cover: ELPC07W
Air Filter: ELPAF65
External Camera: ELPEC01
Ceiling Mount: ELPMB22, ELPMB30
Document Camera: ELPDC21, ELPDC30
Wireless Presentation System: ELPWP20

EB-L690E / EB-L890E



© 2025 Epson India Pvt. Ltd. All Rights Reserved. Reproduction in part or in whole, without the written permission from Epson, is strictly prohibited. EPSON is registered trademark of Seiko Epson Corporation. All other products names and other company names used herein are for identification purposes only and are the trademarks or registered trademarks of their respective owners. Epson disclaims any and all rights in those marks. Print samples shown are simulations only. Specifications and product availability are subject to change without notice and may vary between countries. Please check with local Epson offices for more information.

Apple, iPad and iPhone are trademarks of Apple Inc., registered in the U.S. and other countries. App Store is a service mark of Apple Inc.

Android is a trademark of Google Inc.

Dealer's Stamp

Information correct as of October 2025.

SPECIFICATIONS

MODEL NUMBER		EB-L690U	EB-L790U	EB-L890U
SKU Code		V11HB29056	V11HB28056	V11HB27056
Projection Technology				
Specifications of Main Parts				
LCD	Size	0.67" (C2 Fine)		
	Driving Method	Poly-silicon TFT active matrix		
	Pixel Number	2,304,000 dots (1920 x 1200) x 3		
	Native Resolution	WUXGA		
	Aspect Ratio	16:10		
	Pixel Arrangement	Cross stripe		
	Type	Optical Zoom (Manual) / Focus (Manual)		
	F-Number	1.5 – 1.7		
	Focal Length	20.0 – 31.8 mm		
	Zoom Ratio	1.0 - 1.60		
Projection Lens	Throw Ratio	1.35 – 2.20		
	Lens Shift	Vertical: ±50% (Manual) Horizontal: ±20% (Manual)		
	Lightsource	Type	Laser Diode	
	Life (Normal / Extended)	20,000 hours / 30,000 hours		
Screen Size (Projected Distance)				
Zoom: Wide		50" – 500" [1.44 – 14.76 m]		
Zoom: Tele		50" – 500" [2.35 - 23.84 m]		
Brightness ^{*1}				
White Light Output (Normal / Eco)		6,500 lm / 4,550 lm	7,300 lm / 5,110 lm	8,000 lm / 5,600 lm
Colour Light Output		6,500 lm	7,300 lm	8,000 lm
Light Output (Center) ^{*2}		7,100 lm	7,900 lm	8,700 lm
Contrast Ratio				
Over 5,000,000:1				
Geometric Correction				
Projection Orientation		360° Free		
Vertical / Horizontal Keystone		±30° / ±30°		
Connectivity				
Digital Input	HDMI In	2 (HDCP 2.3)		
	HDBaseT	1 (HDCP 2.3)		
USB Input	USB Type A	2 (Port 1: For PC Free, Document Camera, Firmware Update, Copy OSD Settings, Content Playback, ELPEC01 or 5V/2A Power Supply; Port 2: For PC Free, Document Camera, Firmware Update, Copy OSD Settings, Content Playback, ELPEC01 or 5V/0.9A Power Supply)		
	USB Type B	1 (For Firmware Update, Copy OSD Settings)		
Control I/O	RS-232C	1 (D-Sub 9pin)		
Digital Output	HDMI Out	1 (HDCP 2.3, supports only HDMI1 input)		
Audio Output	Stereo Mini	1		
Network	Wired LAN	RJ45 x 1 (100Mbps)		
	Wireless LAN	Built-in		
Miracast				
Certification		Wi-Fi CERTIFIED Miracast R2		
Supported Codec		H.264 (AVC)		
AirPlay 2				
Supported Codec		H.264(AVC), H.265(HEVC), AV1, VP9, MPEG-2, MPEG-4		
Internal Speaker				
		10 W Monaural		
Wireless Specification (Built-in Wireless LAN)				
Supported Speed		IEEE802.11a/b/g/n/ac/ax		
Supported Mode		Infrastructure, Simple AP (Wi-Fi Direct)		
Supported Security Type		Infrastructure: Open, WPA2 / WPA3-PSK, WPA2 / WPA3-EAP Supported EAP Type: PEAP, EAP-TLS Simple AP (Wi-Fi Direct): WPA2-PSK (AES)		
Operating Temperature				
Single Use		Low Altitude (0 - 2,286m/7,500ft): 0 - 45 °C <32 - 113 °F> High Altitude (Over 2,286m/7,500ft): 0 - 40 °C <32 - 104°F> 20% - 80% Humidity, No Condensation		
Multi-Projection Use		Low Altitude (0 - 2,286m/7,500ft): 0 - 40 °C <32 - 104 °F> High Altitude (Over 2,286m/7,500ft): 0 - 35 °C <32 - 95°F> 20% - 80% Humidity, No Condensation		
Operating Altitude				
		Over 1,500m/4,921ft with High Altitude Mode: 0 - 3,048m (0 -10,000ft)		
Direct Power On / Off				
		Yes		
Start-Up Period				
		12 seconds (Epson Logo); Warm-up Period: 30 seconds		
Quick Start-Up				
		Less than 8 seconds (Display)		
Cool Down Period				
		Instant Off		
Air Filter	Type	Electrostatic Filter		
	Maintenance Cycle ^{*3}	20,000 hours (Normal) / 30,000 hours (Extended)		
Power Supply Voltage				
		100 - 240 V AC ±10%, 50/60 Hz		
Power Consumption (220 - 240V)				
Laser Diode On	Normal	399 W		450 W
	Extended	295 W		330 W
Standby (Normal / Eco)		2.4 W / 0.4 W		
Dimension Excluding Feet (W x D x H)				
		440 x 304 x 122 mm		
Weight				
		Approx. 8.2kg		Approx. 8.5kg
Fan Noise (Normal / Eco)				
		32dB / 25dB		36dB / 26dB

SPECIFICATIONS

MODEL NUMBER		EB-L900SE	EB-L790SE	
SKU Code		V11HB36056	V11HB26056	
Projection Technology		RGB liquid crystal shutter projection system (3LCD)		
Specifications of Main Parts				
LCD	Size	0.67" (C2 Fine)		
	Driving Method	Poly-silicon TFT active matrix		
	Pixel Number	2,304,000 dots (1920 x 1200) x 3		
	Native Resolution	WUXGA (4K Enhancement)		
	Aspect Ratio	16:10		
	Pixel Arrangement	Cross stripe		
	Projection Lens	Type	Optical Zoom (Manual) / Focus (Manual) / Distortion (Manual)	
F-Number		1.8 - 2.0	1.7 - 2.1	
Focal Length		7.54 - 10.55 mm	11.6 - 19.9 mm	
Zoom Ratio		1.0 - 1.4	1.0 - 1.7	
Throw Ratio		0.5 - 0.7	0.79 - 1.36	
Lens Shift		Vertical: ±50% (Manual) Horizontal: ±20% (Manual)		
Lightsource		Type	Laser Diode	
	Life (Normal / Extended)	20,000 hours / 30,000 hours		
Screen Size (Projected Distance)				
Zoom: Wide		100" - 500" [1.09 - 5.58 m]	60" - 400" [1.02 - 6.95 m]	
Zoom: Tele		100" - 500" [1.54 - 7.84 m]	60" - 400" [1.75 - 11.89 m]	
Brightness¹⁾				
White Light Output (Normal / Eco)		6,000 lm / 4,200 lm	7,000 lm / 4,900 lm	
Colour Light Output		6,000 lm	7,000 lm	
Light Output (Center) ²⁾		6,500 lm	7,600 lm	
Contrast Ratio		Over 5,000,000:1		
Geometric Correction				
Projection Orientation		360° Free		
Vertical / Horizontal Keystone		±25° / ±25°	±30° / ±30°	
Connectivity				
Digital Input	HDMI In	2 (HDCP 2.3)		
	HDBaseT	1 (HDCP 2.3)		
USB Input	USB Type A	2 (Port 1: For PC Free, Document Camera, Firmware update, Copy OSD Settings, Content playback, ELPEC01, Wireless LAN or 5V/2A Power Supply Port 2: For PC Free, Document Camera, Firmware update, Copy OSD Settings, Content playback, ELPEC01, Wireless LAN or 5V/0.9A Power Supply)		
		2 (Port 1: For PC Free, Document Camera, Firmware update, Copy OSD Settings, Content playback, ELPEC01 or 5V/2A Power Supply) Port 2: For PC Free, Document Camera, Firmware update, Copy OSD Settings, Content playback, ELPEC01 or 5V/0.9A Power Supply)		
Control I/O	USB Type B	1 (For Firmware Update, Copy OSD Settings)		
Digital Output	RS-232C	1 (D-Sub 9pin)		
Audio Output	HDMI Out	1 (HDCP 2.3, supports only HDMI1 input)		
Network	Stereo Mini	1		
	Wired LAN	RJ45 x 1 (100Mbps)		
	Wireless LAN	Optional	Built-in	
Miracast				
Certification		N/A	Wi-Fi CERTIFIED Miracast R2	
Supported Codec		N/A	H.264 (AVC)	
AirPlay 2				
Supported Codec		N/A	H.264(AVC), H.265(HEVC), AV1, VP9, MPEG-2, MPEG-4	
Internal Speaker		N/A	10 W Monaural	
Wireless Specification (Built-in Wireless LAN)				
Supported Speed		N/A	IEEE802.11a/b/g/n/ac/ax	
Supported Mode		N/A	Infrastructure, Simple AP (Wi-Fi Direct)	
Supported Security Type		N/A	Infrastructure: Open, WPA2 / WPA3-PSK, WPA2 / WPA3-EAP Supported EAP Type: PEAP, EAP-TLS Simple AP (Wi-Fi Direct): WPA2-PSK (AES)	
Wireless Specification (Optional Wireless LAN ELPA111)				
Supported Speed		Infrastructure: IEEE 802.11b (2.4GHz): 11 Mbps ³⁾ , IEEE 802.11g (2.4GHz): 54 Mbps ³⁾ , IEEE 802.11n (2.4GHz): 72.2 Mbps ³⁾ , IEEE 802.11a (5GHz): 54 Mbps ³⁾ , IEEE 802.11n (5GHz): 150 Mbps ³⁾ , IEEE 802.11ac (5GHz): 325 Mbps ³⁾ Access Point (Wi-Fi Direct): IEEE 802.11g (2.4GHz): 54 Mbps ³⁾ , IEEE 802.11n (2.4GHz): 72.2 Mbps ³⁾ , IEEE 802.11a (5GHz): 54 Mbps ³⁾ , IEEE 802.11n (5GHz): 150 Mbps ³⁾ , IEEE 802.11ac (5GHz): 325 Mbps ³⁾	N/A	
Supported Mode	Infrastructure, Access Point (Wi-Fi Direct)	N/A		
Supported Security Type	Infrastructure: Open, WPA2 / WPA3-PSK, WPA2 / WPA3-EAP Supported EAP Type: PEAP, EAP-TLS, EAP-Fast Access Point (Wi-Fi Direct): WPA2-PSK (AES)	N/A		
Operating Temperature				
Single Use		Low Altitude (0 - 2,286m/7,500ft): 0 - 45 °C <32 - 113 °F> High Altitude (Over 2,286m/7,500ft): 0 - 40 °C <32 - 104°F> 20% - 80% Humidity, No Condensation		
Multi-Projection Use		Low Altitude (0 - 2,286m/7,500ft): 0 - 40 °C <32 - 104 °F> High Altitude (Over 2,286m/7,500ft): 0 - 35 °C <32 - 95°F> 20% - 80% Humidity, No Condensation		
		Over 1,500m/4,921ft with High Altitude Mode: 0 - 3,048m (0 -10,000ft)		
Operating Altitude		Yes		
Direct Power On / Off		12 seconds (Epson Logo); Warm-up Period: 30 seconds		
Start-Up Period		Less than 8 seconds (Display)		
Quick Start-Up		Instant Off		
Cool Down Period				
Air Filter	Type	Electrostatic Filter		
	Maintenance Cycle ⁴⁾	20,000 hours (Normal) / 30,000 hours (Extended)		
Power Supply Voltage		100 - 240 V AC ±10%, 50/60 Hz		
Power Consumption (220 - 240V)				
Laser Diode On	Normal	415 W	450 W	
	Extended	303 W	330 W	
Standby (Normal / Eco)		2.4 W / 0.4 W		
Dimension Excluding Feet [W x D x H]		440 x 304 x 122 mm		
Weight		Approx. 9.3kg		
Fan Noise (Normal / Eco)		36dB / 26dB		

¹ Colour brightness (colour light output) and white brightness (white light output) will vary depending on usage conditions. Colour light output measured in accordance with IDMS 15:4; white light output measured in accordance with ISO 21118.

² This light output value is measured at the centre of the screen as a reference value. There is no official standard for light output (Centre) measurements and this measurement is made based on the method set by Epson.

^{*3} These modes and actual data throughputs depend on supported wireless mode of source devices and/or environment conditions.

^{*4} When used in the general office environment (the amount of floating dust: 0.04 - 0.2 mg/m³). Based on the Epson's in-house test results.

Supplied Accessories

Power Cable: 3m, 3 wire

Remote Control: Yes, with Alkaline AA Battery

User Guide

Optional Accessories

Cable Cover: ELPCC07W

Air Filter: ELPAF65

External Camera: ELPEC01

Wireless LAN unit: ELPAP11*

Ceiling Mount: ELPMB22, ELPMB30

Document Camera: ELPDC21, ELPDC30

Wireless Presentation System: ELPWP20**

*Only for EB-L690SE. **Only for EB-L790SE.

EB-L690SE / EB-L790SE



© 2025 Epson India Pvt. Ltd. All Rights Reserved. Reproduction in part or in whole, without the written permission from Epson, is strictly prohibited. EPSON is registered trademark of Seiko Epson Corporation. All other products names and other company names used herein are for identification purposes only and are the trademarks or registered trademarks of their respective owners. Epson disclaims any and all rights in those marks. Print samples shown are simulations only. Specifications and product availability are subject to change without notice and may vary between countries. Please check with local Epson offices for more information.

Apple, iPad and iPhone are trademarks of Apple Inc., registered in the U.S. and other countries. App Store is a service mark of Apple Inc.

Android is a trademark of Google Inc.

Dealer's Stamp

Information correct as of October 2025.

SPECIFICATIONS

MODEL NUMBER		EB-L690SU
SKU Code		V11HB31056
Projection Technology		RGB liquid crystal shutter projection system (3LCD)
Specifications of Main Parts		
LCD	Size	0.67" (C2 Fine)
	Driving Method	Poly-silicon TFT active matrix
	Pixel Number	2,304,000 dots (1920 x 1200) x 3
	Native Resolution	WUXGA
	Aspect Ratio	16:10
Projection Lens	Pixel Arrangement	Cross stripe
	Type	Optical Zoom (Manual) / Focus (Manual) / Distortion (Manual)
	F-Number	1.7 – 2.1
	Focal Length	11.6 – 19.9 mm
	Zoom Ratio	1.0 - 1.7
Lightsource	Throw Ratio	0.79 – 1.36
	Lens Shift	Vertical: ±50% (Manual) Horizontal: ±20% (Manual)
	Type	Laser Diode
	Life (Normal / Extended)	20,000 hours / 30,000 hours
	Screen Size (Projected Distance)	
Zoom: Wide	60" – 400" [1.02 – 6.95 m]	
Zoom: Tele	60" – 400" [1.75 – 11.89 m]	
Brightness^{*1}		
White Light Output (Normal / Eco)	6,200 lm / 4,340 lm	
Colour Light Output	6,200 lm	
Light Output (Center) ^{*2}	6,700 lm	
Contrast Ratio		Over 5,000,000:1
Geometric Correction		
Projection Orientation	360° Free	
Vertical / Horizontal Keystone	±30° / ±30°	
Connectivity		
Digital Input	HDMI In	2 (HDCP 2.3)
	HDBaseT	1 (HDCP 2.3)
USB Input	USB Type A	2 (Port 1: For PC Free, Document Camera, Firmware Update, Copy OSD Settings, Content Playback, ELPEC01 or 5V/2A Power Supply; Port 2: For PC Free, Document Camera, Firmware Update, Copy OSD Settings, Content Playback, ELPEC01 or 5V/0.9A Power Supply)
	USB Type B	1 (For Firmware Update, Copy OSD Settings)
Control I/O	RS-232C	1 (D-Sub 9pin)
Digital Output	HDMI Out	1 (HDCP 2.3, supports only HDMI1 input)
Audio Output	Stereo Mini	1
Network	Wired LAN	RJ45 x 1 (100Mbps)
	Wireless LAN	Built-in
Miracast		
Certification	Wi-Fi CERTIFIED Miracast R2	
Supported Codec	H.264 (AVC)	
AirPlay 2		
Supported Codec	H.264(AVC), H.265(HEVC), AV1, VP9, MPEG-2, MPEG-4	
	10 W Monaural	
Internal Speaker		
Wireless Specification (Built-in Wireless LAN)		
Supported Speed	IEEE 802.11a/b/g/n/ac/ax	
Supported Mode	Infrastructure, Simple AP (Wi-Fi Direct)	
Supported Security Type	Infrastructure: Open, WPA2 / WPA3-PSK, WPA2 / WPA3-EAP Supported EAP Type: PEAP, EAP-TLS Simple AP (Wi-Fi Direct): WPA2-PSK (AES)	
Operating Temperature		
Single Use	Low Altitude (0 - 2,286m/7,500ft): 0 - 45 °C <32 - 113 °F> High Altitude (Over 2,286m/7,500ft): 0 - 40 °C <32 - 104°F> 20% - 80% Humidity, No Condensation	
Multi-Projection Use	Low Altitude (0 - 2,286m/7,500ft): 0 - 40 °C <32 - 104 °F> High Altitude (Over 2,286m/7,500ft): 0 - 35 °C <32 - 95°F> 20% - 80% Humidity, No Condensation	
Operating Altitude		
Direct Power On / Off	Over 1,500m/4,921ft with High Altitude Mode: 0 - 3,048m (0 -10,000ft)	
Start-Up Power On / Off		
Start-Up Period	Yes	
Quick Start-Up	12 seconds (Epson Logo); Warm-up Period: 30 seconds	
Cool Down Period	Less than 8 seconds (Display)	
Air Filter	Type	Instant Off
	Maintenance Cycle ^{*3}	Electrostatic Filter
Power Supply Voltage	20,000 hours (Normal) / 30,000 hours (Extended)	
Power Consumption (220 - 240V)	100 - 240 V AC ±10%, 50/60 Hz	
Laser Diode On	Normal	399 W
	Extended	295 W
Standby (Normal / Eco)	2.4 W / 0.4 W	
Dimension Excluding Feet (W x D x H)	440 x 304 x 122 mm	
Weight	Approx. 8.9kg	
Fan Noise (Normal / Eco)	34dB / 25dB	

^{*)} Colour brightness (colour light output) and white brightness (white light output) will vary depending on usage conditions. Colour light output measured in accordance with IDMS 15:4; white light output measured in accordance with ISO 21118.

² This light output value is measured at the centre of the screen as a reference value. There is no official standard for light output (Centre) measurements and this measurement is made based on the method set by Epson.

^{*3} When used in the general office environment (the amount of floating dust: 0.04 - 0.2 mg/m³). Based on the Epson's in-house test results.

Supplied Accessories

Power Cable: 3m, 3 wire

Remote Control: Yes, with Alkaline AA Battery

User Guide

Optional Accessories

Cable Cover: ELPCC07W

Air Filter: ELPAF65

External Camera: ELPEC01

Ceiling Mount: ELPMB22, ELPMB30

Document Camera: ELPDC21, ELPDC30

Wireless Presentation System: ELPWP20

EB-L690SU



© 2025 Epson India Pvt. Ltd. All Rights Reserved. Reproduction in part or in whole, without the written permission from Epson, is strictly prohibited. EPSON is registered trademark of Seiko Epson Corporation. All other products names and other company names used herein are for identification purposes only and are the trademarks or registered trademarks of their respective owners. Epson disclaims any and all rights in those marks. Print samples shown are simulations only. Specifications and product availability are subject to change without notice and may vary between countries. Please check with local Epson offices for more information.

Apple, iPad and iPhone are trademarks of Apple Inc., registered in the U.S. and other countries. App Store is a service mark of Apple Inc.

Android is a trademark of Google Inc

Dealer's Stamp

Information correct as of October 2025.

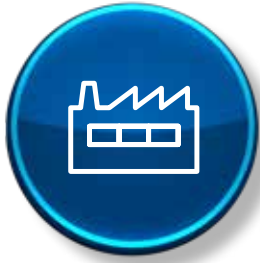

Efforts to mitigate environmental impacts in manufacturing



Toyoshina plant in Japan

Production Using **100%** Renewable Electricity

In December 2023, Epson transitioned to 100% renewable electricity at virtually all its global sites¹, marking a first for both the Japanese manufacturing sector² and the global projector industry³. This shift covers approximately 876 GWh⁴ of annual electricity, reducing CO2 emissions by around 400,000 tonnes per year.

By selecting optimal renewable sources like hydropower and geothermal, and investing in self-generation, Epson achieved its renewable energy goal within 2 years and 10 months of committing to do so in 2021. This includes the entire production process of Epson projectors, from design and development to manufacturing and assembly.

Over **80%** Recycled Cardboard Packaging

All carton box packaging of Epson's projectors is made with over 80% recycled cardboard. Additionally, we are further committed to sustainability by using 100% pulp as cushion material, replacing expanded Polystyrene (EPS), and reducing environmental impact.



Closed Resource Loop

We strive to use resources more effectively by reducing the size and weight of products and utilising more recycled materials. In our EB-L890E series, we use 65% post consumer resin (PCR) material for the projector main body and 100% recycled pulp mold for the packaging.

¹ Among Japanese companies that have joined the RE100. Current as of January 9, 2024, per Epson research.
² Excludes some sales sites and leased properties where the amount of electricity consumed cannot be determined
³ GHG (Greenhouse Gas), GHG scope 1, 2, 3 emission

EPSON INDIA PVT. LTD.

11th Floor, Godrej Centre, Hebbal, Survey No.26, Bellary Road, Sahakar Nagar, Byatarayanapura, Bangalore 560 092, Karnataka.
Tel: 080 6939 5000. Fax: 080 6939 5005



Epson Helpline: For product info or service - 1800 425 0011
For service: 1800 123 001 600 or 1860 3000 1600 (9 am - 6 pm) (Mon - Sat)
Email: emp@eid.epson.co.in