

EPSON
EXCEED YOUR VISION



Reliable, Ultra-Fast Receipt Printer
with state of the Art Mobile Connectivity

Epson TM-T88VI
POS Thermal Printer

Introducing the TM-T88VI series

Building on a strong history of innovation, the TM-T88VI is Epson's greatest POS printer. Shaped by the latest market trends and demands, the TM-T88VI builds on the success of the TM-T88V and remains compatible with its predecessor's software and hardware.

Direct comparisons with the TM-T88V reveal the TM-T88VI to be up to:

17%
faster

82%
more power
efficient

49%
more paper
efficient

The TM-T88VI range comes loaded with features and enhancements to help you grow your business:



What's happen in the market??

One in five consumers will leave a store if queues are too long*. By utilising the TM-T88VI and assisted selling, you can help capture those lost sales.



* Interconnection Consulting, 2013

Strong Connectivity Printing from multi-interfaces

With keeping compatibility, having an unique differentiator.

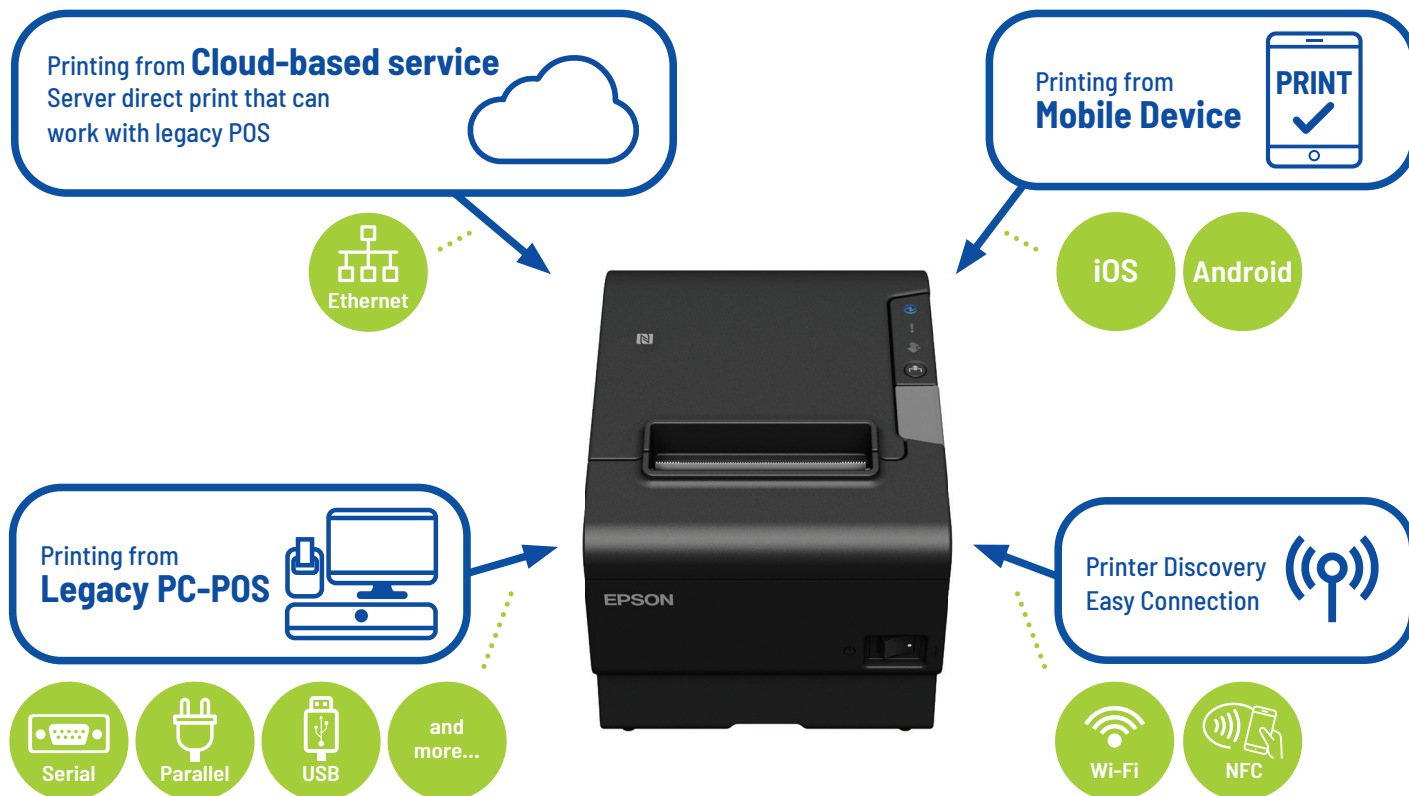

Intelligent Features

Tiny computing capability enables to provide user-defined on-board web services or application.

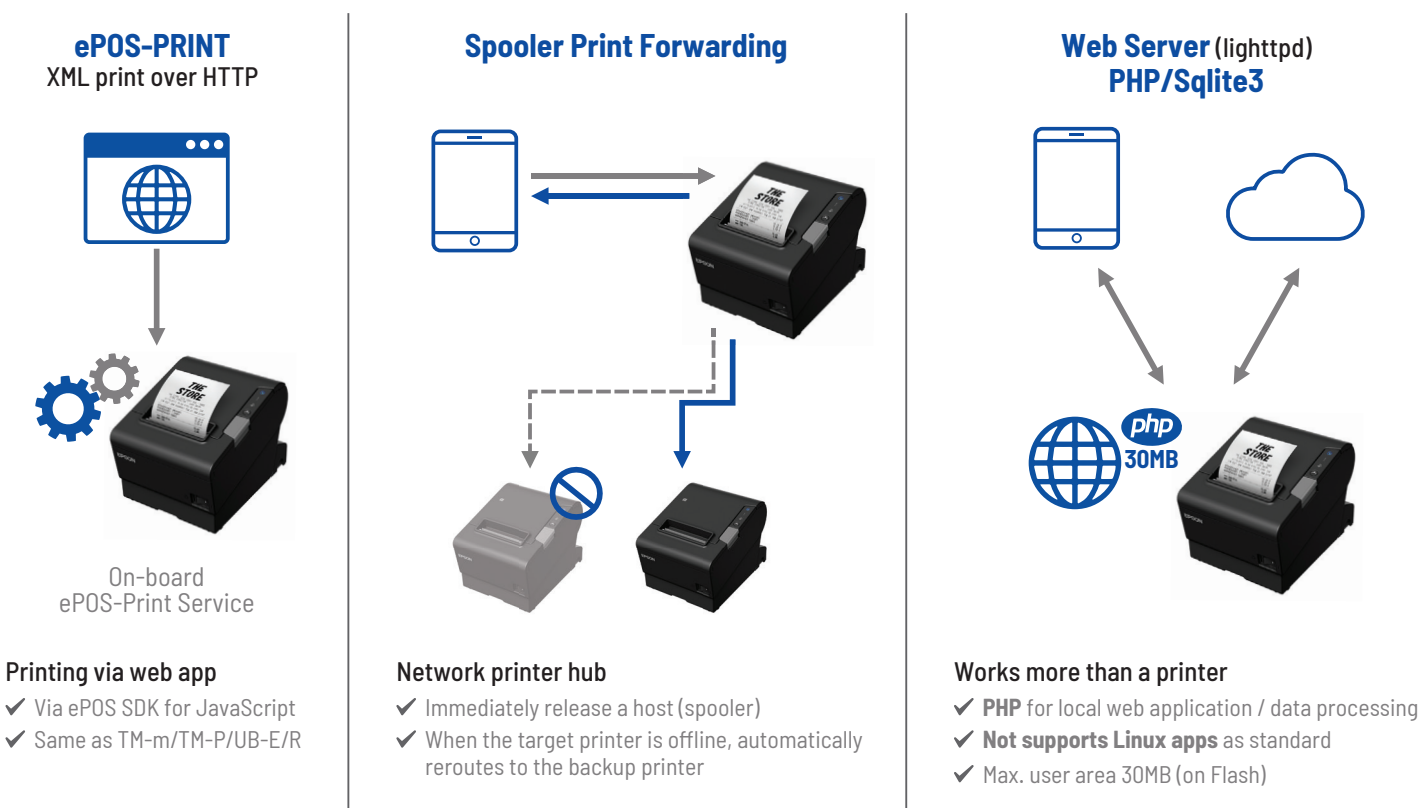

Product Specifications

TM-T88VI

Printing method		Thermal line printing
Cutting method		Partial cut (cutting with one point in left edge left uncut)
Roll paper (single-ply) width		80 mm width paper printing: 79.5 ± 0.5 mm (3.13 ± 0.02") 58 mm width paper printing: 57.5 ± 0.5 mm (2.26 ± 0.02")
Interfaces		USB: USB 2.0 Full-speed (12Mbps) / Wired LAN: 10BASE-T/100BASE-TX Serial: RS-232 / Wireless LAN: Connects an optional Wireless LAN unit to the USB connector. Parallel: IEEE1284
Buffers	Receive buffer Downloaded buffer NV graphics data Web Contents Area	4 KB/45 bytes (selectable using DIP switch 1-2) 12 KB (both for user-defined characters and downloaded images) 384 KB 30 MB
Barcode/two-dimensional symbol		UPC-A, UPC-E, JAN8 / EAN8, JAN13 / EAN13, Code39, Code93, Code128, ITF, CODABAR(NW-7), GS1-128, GS1 DataBar, PDF417, QR code, Maxi, Code, Data Matrix, Aztec Code, Two-dimensional GS1 DataBar, Composite Symbology
Cash drawer function		2 drives
Supplied voltage		DC 24 V ± 7%
Dot density		180 × 180 dpi
Printing width		80 mm width paper printing: 72.0 mm (2.83"), 512 dots 58 mm width paper printing: 50.8 mm (2.0"), 360 dots
Number of characters		Alphanumeric characters: 95 Extended graphics: 128 × 43 pages (including user-defined page) International characters: 18 sets Big 5: 13,535 128 characters × 3 pages (133 character types)
Character structure (W × H dots)		Font A (default): 12 × 24 (including 2-dot horizontal spacing) Font B: 9 × 17 (including 2-dot horizontal spacing) Kanji Font A: 24 × 24
Maximum print speed*1		350mm/s**
Line spacing		4.23 mm {1/6"} (Default value, programmable by command)
Life	Mechanism Thermal head Autocutter MTBF MCCBF	20 million lines 200 million pulses, 200 km 3 million cuts 360,000 hours 70 million lines
Temperature/humidity		Operating: 5 to 45°C {41 to 113°F}, 10 to 90% RH
Product dimensions		Storage: -10 to 50°C {14 to 122°F}, 10 to 90% RH 145 × 195 × 148 mm {5.71 × 7.68 × 5.83"} (W × D × H)
Product weight		Approx. 1.6 kg {3.5 lb} (roll paper excluded)

What's in the box:

- Printer
- TM-T88VI Software & Documents Disc
- AC adapter (PS-180)
- Bottom cover for Connector cover
- Connector cover
- Screws
- Setup guide
- Roll paper (for testing)
- Roll paper guide
- Power switch cover

Option:

- WH-10 Wall hanging bracket
- OT-WL02 (Wireless LAN Dongle 2.4GHz)

** Speed based on using 80 mm wide media only and Epson's PS-180 power supply. Configurations not including the PS-180 will have a default print speed of 300 mm/sec.

Epson is the registered trademark of Seiko Epson Corporation. All other names and company names used herein are for identification purpose only and may be the trademarks or registered trademarks of their respective owners. Epson disclaim any and all rights in those marks. All print samples shown herein are simulations. Specifications are subject to change without notice.

EPSON
EXCEED YOUR VISION

Please call our sales hotlines for demonstration at our showroom.

Epson Hong Kong Limited

Unit 715-723, 7/F Trade Square,
681 Cheung Sha Wan Road,
Cheung Sha Wan, Kowloon, Hong Kong

HK Sales Hotline : (852) 2827 8711
HK Technical Hotline : (852) 2827 8911
Macau Hotline : (852) 2850 8065

Epson Authorized Customer Service Centre Wah Fung Computer Services Ltd.

Unit 901, 9/F, Westin Centre, 26 Hung To Road,
Kwun Tong, Kowloon, Hong Kong

www.epson.com.hk



Feb19-01-TM-T88VI