

EPSON®

Thermal Receipt Printer TM-m50II POS

Receipt Printer POS



Modern and compact receipt printer, ideal for high-volume use

Main features

- **Modern and compact design:** sleek 3" thermal receipt printer; small size; supports both front and top paper exits; standard near-end sensor.
- **Designed for traditional PC-POS and mPOS systems:** supports both legacy and new connectivity interfaces.
- **Engineered for reliability:** 4-year limited warranty; long-lasting printhead (200 km) and auto cutter (2.2 million cuts)¹.
- **Ultra fast transactions:** print speeds up to 500 mm/sec².
- **Versatile connectivity:** built-in interfaces; serial, USB and Ethernet; optional Wi-Fi[®] adapter available.
- **Ready for cloud printing and online ordering:** Server Direct Print available to retrieve print jobs directly from the cloud³.
- **Paper-saving feature:** reduce paper usage by up to 49 percent⁴.
- **Enhanced enclosure:** IPX2-rated enclosure is water-resistant; antimicrobial and easy to clean.

TM-m50II POS

Specification sheet

Print		Reliability ¹		Eco Features	
Print Method	Thermal	Printer Reliability	20 million printing lines	Paper-Saving Mode	
Print Speed ²	500 mm/sec	MTBF	360,000 hours	ENERGY STAR [®] qualified	
Print Resolution	180 dpi	MCFB	70,000,000 lines	RoHS compliant	
Print Direction	Vertical and horizontal	Auto Cutter Reliability	2.2 million cuts	Recyclable product ⁶	
Print Fonts		General		Warranty	
Fonts/Column Capacity	Font A: 12 x 24, 42 cpl (default); Font B: 9 x 24, 56 cpl; Kanji Font A: 24 x 24, 24 cpl; Kanji Font B: 16 x 16 x 32 cpl (Korean).	Paper Exit and Loading	Top or Front	Standard 2-year limited warranty.	
Character Size	Font A: 1.41 mm x 3.39 mm; Font B: 0.99 mm x 3.39 mm; Kanji Font A: 3.39 mm x 3.39 mm; Kanji Font B: 2.26 mm x 2.26 mm	Spill Resistance	IPX2 rated (front exit only)	Optional extended warranty available ⁷	
Character Set	95 Alphanumeric, 18 International, 128 x 43 Graphic, Japanese (11,233 characters of JIS X0213:2004, 1 special character), Simplified Chinese (28,553 characters of GB18030-2000), Traditional Chinese (13,535 characters of Big5), Korean (8,224 characters of KSC5601)	NV Bit Image Memory	12 KB (maximum)		
Barcode	UPC-A, UPC-E, JAN8/EAN8, JAN13/EAN13, Code39, Code93, Code128, ITF, CODABAR (NW-7), GS1-128, GS1 DataBar, Code 128 Auto	NV Graphics	384 KB (maximum)		
Two-Dimensional Symbol Printing	PDF417, QR Code, MaxiCode, DataMatrix, Aztec Code, Two-Dimensional GS1 DataBar, Composite Symbology	Receive Buffer	4 KB or 45 bytes		
		Development Kit	Kit Epson® ePOS™ SDK (iOS®, Android™, JavaScript®), TM Print Assistant (iOS®, Android™), OPOS ADK/OPOS ADK for .NET (Windows®), JavaPOS ADK (Windows®, Linux®)	What's in the Box	
		Drivers	Epson Advanced Printer Driver (APD), TM Virtual Port Driver, Mac Printer Driver, CUPS Driver	TM-m50II, Power Supply PS-190 with AC Cable, Starter Receipt Paper Roll, Setup Guide, 58 mm Roll Paper Guide	
		Software	TM Utility (iOS®, Android™), TM-m50II Utility (Windows Desktop), EpsonNet Config (Windows®, Mac®), TM Deployment Tool, Monitoring Tool, Epson Firmware Updater	Ordering Information	
		Audible Alert	Optional External Buzzer (OT-BZ20)	Model Number	Color*
		LED Indicators	Power, Error, Paper, Ethernet	TM-m50II	ENB9
		Sensors	Paper End, Cover Open, Near-End Sensor	TM-m50II	EBCK
		D.K.D. Function	Yes		Part Number
		Power Consumption	Operating 39.1 W, Standby 1.6 W (AC 115 V/60 Hz)		C32C881017
		Power Supply	PS-190		C32C890634
		Power Saving	Yes		C32C890634
		Temperature	5 °C to 45 °C		A61CF26111
		Relative Humidity	10% – 90%		A61CF26111
		Acoustic Noise Level	55 dBA		A61CF26111
		Standards and Approvals	EMI FCC Class A, ICES-003 Class A Safety Standard UL62368-1/CSA C22.2 No.62368-1		A61CF26111
		Dimensions	(W x D x H) 5" x 5" x 5", 127 mm x 128 mm x 129 mm		C32C891326
		Weight	2.87 lb/1,300 g		C32C824A8761
		Color	ENB9 (Epson White), EBCK (Epson Black)		
		Cash Drawer Kick	Yes		
		Cloud Printing Ready ³	Via Server Direct Print technology		
		USB POS Peripheral Device	1		
Media Handling					
Media Dimensions	80 mm: 79.5 ± 0.5 x 83 mm 3.13" ± 0.02" (width) x 3.27" (roll diameter)				
	58 mm: 57.5 ± 0.5 x 83 mm 2.26" ± 0.02" (width) x 3.27" (roll diameter)				
Thickness	48 µm – 80 µm				
Type	Thermal roll paper				
Paper Feed Method	Friction feed				
Paper Back Feed	Yes				
Width	3.12"/79.5 mm				
Paper Loading	Drop-in				
Roll Diameter (Maximum)	3.27"/83 mm				
Core Diameter (Minimum)	0.71"/18 mm				
Paper Guide	80 mm (default), 58 mm spacer included				
Auto Cutter	Partial cut (default) or full cut				
Connectivity					
Interface	USB Type-B (USB 2.0 FS) Ethernet (10/100Base-T/TX) Serial (RS-232C)				
	USB Type-A peripheral device port x 1				
Supported Operating Systems	iOS®, Android™, Windows®, Mac® OS X®, GNU (Linux®)				
Easy Setting Function	NFC®, QR code				
Easy Setting Tool	TM Utility (iOS®, Android™), TM-m50II Utility (Windows®), EpsonNet Config				

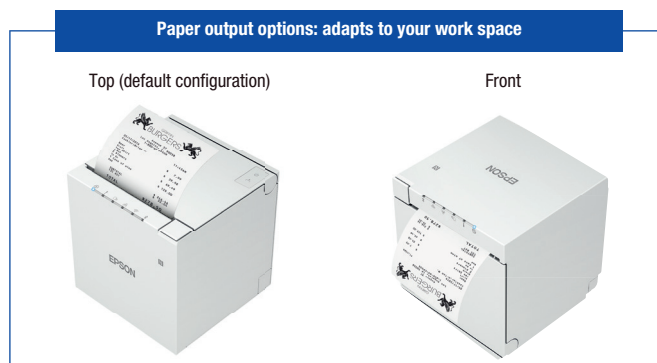
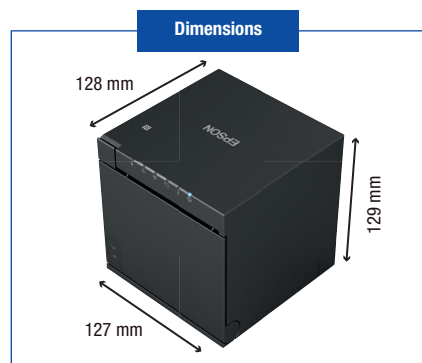

¹ Epson's statements about reliability levels are only estimates, based on normal use of the printer using tested media only. See www.epson.com/testedmedia for more information on Tested Media. These reliability statements are not warranties of the media or Epson's printers, and the only warranties for printers are the limited warranty statements for each printer. ² Speed based on using approved Epson media. For more information, please visit www.epson.com/testedmedia. ³ Internet connection required. For availability, contact your local provider. ⁴ Paper savings depend on the text and graphics printed on the receipt. ⁵ NFC tag requires use of a device that includes NFC reader, and may require additional software. ⁶ For convenient and reasonable recycling options, visit www.epson.com/recycle. ⁷ See individual service plan for details.

Authorized distributor:

www.latin.epson.com/pos

In Latin America, call the nearest office or your authorized distributor. Epson subsidiaries:

Epson Argentina S.R.L. (0800) 288 37766	Epson Bolivia (800) 100 116	Epson Centroamérica (506) 2588 7800	Epson Chile S.A. (562) 2484 3400	Epson Colombia Ltda. (571) 602 4750	Epson México S.A. de C.V. (5255) 1323 2000	Epson Perú S.A. (511) 418 0210
--	--------------------------------	--	-------------------------------------	--	---	-----------------------------------

Specifications and terms are subject to change without notice. EPSON is a registered trademark of Seiko Epson Corporation. ePOS is a trademark and Epson Preferred is a service mark of Epson America, Inc. Mac and OS X are trademarks of Apple Inc., registered in the U.S. and other countries. Android is a trademark of Google LLC. Windows is either a registered trademark or trademark of Microsoft Corporation in the United States and other countries. Wi-Fi is a registered trademark of Wi-Fi Alliance®. All other product and brand names are trademarks and/or registered trademarks of their respective companies. Epson disclaims any and all rights in these marks. Copyright 2024 Epson America, Inc. Com-SS-Oct-13 CPD-62921 03/24