

## SPECIFICATIONS

<b>Model Number</b>	V39II	
<b>SKU Code</b>	B11B268502	
<b>Scanner</b>	A4 Flatbed Colour Image Scanner	
Scanner Type	A4 Flatbed Colour Image Scanner	
Sensor Type	Contact Image Sensors (CIS)	
Scanning Method	Fixed document and moving carriage	
Light Source	RGB LED	
Optical Resolution *1	4,800 x 4,800 dpi	
Output Resolution	50 – 4,800 dpi (in 1 dpi increments), 7,200 dpi, 9,600 dpi	
Bit Depth		
Colour	48-bit input, 24-bit output	
Grayscale	16-bit input, 8-bit output	
Black and White	16-bit input, 1-bit output	
Maximum Document Size	216 x 297 mm	
Interface	USB 2.0	
<b>Scanning Speed *2</b>		
Reflective	<b>DPI</b>	<b>Speed</b>
Monochrome	300	10 sec
	600	12 sec
	1,200	37 sec
24-bit Colour	300	10 sec
	600	29 sec
	1,200	103 sec
<b>Drivers and Software</b>		
Supported OS (Scanner Driver)		
Windows	Windows 7 / 8 / 8.1 / 10 / 11, Server 2003 / 2008 / 2012 / 2016 / 2019	
Mac	Mac OS X 10.11 or later	
Driver Compatibility	TWAIN, SANE, WIA, ICA	
Bundled Software	Epson Scan 2 Epson Scan OCR Component Epson ScanSmart	
File Format	Epson Scan 2: JPEG, TIFF, Multi-TIFF, PDF, Searchable PDF, BMP, PNG Epson ScanSmart: JPEG, PDF, Searchable PDF, TIFF, Multi-TIFF, PNG, BMP	
<b>Electrical Specifications</b>		
Rated Voltage	AC 100 - 240 V	
Rated Frequency	50 - 60 Hz	
Power Consumption		
Operating	2.5 W	
Ready Mode	1.1 W	
PowerOff0.0125W		
<b>Environmental Conditions</b>		
Temperature		
Operating	10 - 35 °C	
Storage	-20 - 60 °C	
Humidity		
Operating	20 - 80 % (No Condensation)	
Storage	20 - 85 % (No Condensation)	
<b>Option</b>	<b>Order Code</b>	
Flatbed Dock	B12B819011	

\*1 Scanning resolution as defined by ISO14473.

\*2 Based on A4 documents.

## Dimensions & Weight

### V39II

Weight: 1.4 kg (3.1 lb)

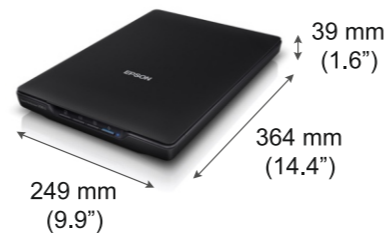

### What's in the box:

- Scanner Main Unit
- USB 2.0 Cable
- Setup Guide

©2023 Epson India Pvt. Ltd. All Rights Reserved. Reproduction in part or in whole, without the written permission from Epson, is strictly prohibited.

EPSON and EXCEED YOUR VISION are registered trademarks of Seiko Epson Corporation.

All other product names and other company names used herein are for identification purposes only and are the trademarks or registered trademarks of their respective owners.

Epson disclaims any and all right in those marks. Projected images shown herein are simulations. The actual product design and contents may vary. Specifications are subject to change without notice and may vary between countries. Please check with local Epson offices for more information.

Apple, iPad and iPhone are trademarks of Apple Inc., registered in U.S. and other countries. App Store is a service mark of Apple Inc.

Android is a trademark of Google Inc.

Information correct at time of printing.  
Printed April 2023

## SCANNER PERFECTION™ V39II

# EPSON



# COMPACT AND VERSATILE PHOTO SCANNING ON-THE-GO.

## High quality scanning for photos and documents with easy-to-use features.

The Epson Perfection™ V39II combines exceptional scanning quality with superior scanning capabilities to capture the finest details. Compact and light, the V39II is designed to save space, reduce clutter and enhance mobility. And with the built-in kickstand, you can scan even in an upright position, regardless of the space restrictions you may have.

Remember, **it's in the details.** Visit [epson.co.in/scanners](http://epson.co.in/scanners) for more information.

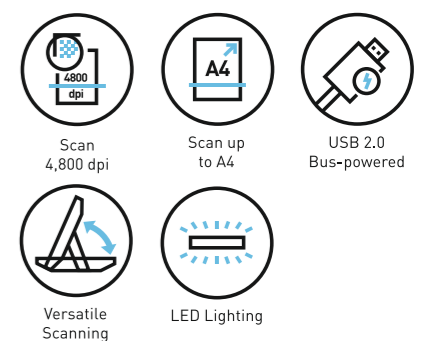

## IT'S IN THE DETAILS.

### Superior Convenience

Simply connect the scanner via USB to a PC or laptop to start scanning anywhere, anytime.

### Remarkable Versatility

Use your scanner in limited spaces with the built-in kickstand and sleek compact design.

### User-Friendly Functions

With the extendable hinge and detachable lid, you can easily scan thick documents and books.

EPSON INDIA PVT. LTD.  
12th Floor, The Millennia, Tower A, No. 1,  
Murphy Road, Ulsoor, Bangalore - 560 008.  
Tel: 080-4566 5000 Fax: 080-4566 5005

Regional Offices:  
Ahmedabad 4037 0075, Chennai 9967 7500, Ernakulam 4012 315, Coimbatore 98942 19200,  
Hyderabad 4857 0032, Jaipur 4923 119, Kolkata 4603 4714/15/29/30, Mumbai 3079 8200,  
New Delhi 4107 3101, 4752 2414, Pune 3028 6000



Epson Helpline: For product info or service - 1800 425 0011  
For service: 1800 123 001 600 (9AM - 6PM) (Mon-Sat)  
Email: [emp@eid.epson.co.in](mailto:emp@eid.epson.co.in)

[www.epson.co.in](http://www.epson.co.in)

DISCLAIMER: While efforts have been made to provide accurate information, there could be errors, which may have crept in. In the event of any discrepancy, the Product Operating Instructions supplied with products shall be the authentic reference point. Features, specifications, dimensions, weight and prices mentioned are subject to change without prior notice. Actual products may differ slightly in appearance to illustrations/pictures provided.

Packed with advanced features such as ReadyScan LED Technology and Epson ScanSmart software, this powerful scanner enables you to digitise, view and manage your documents with ease. With its sleek, compact and stylish design, you'll experience excellent scanning performance even on the go.

### Compact Design with Reliable Performance

#### Superior Convenience

Reduce clutter and avoid the hassle of a complicated setup with the V39II. Simply connect the scanner to your PC with a single USB cable to start scanning.

For added convenience, you can power up the V39II with just your laptop's USB port, enabling you to use the scanner anywhere, anytime.



#### Remarkable Versatility

The small and compact design of the V39II makes it easy to carry around. With a built-in kickstand, you can also use the scanner in an upright position at places where space is limited.



### Flexible, User-Friendly Features

#### Pre-defined One-touch Functions

The V39II has 4 one-touch buttons that are pre-defined to make regular scan jobs easier. With just a push of a button, you can effortlessly send scanned documents to PDF, email, printer, or computer directly.

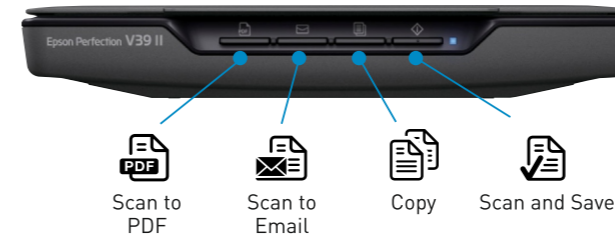

#### Extendable Hinge and Detachable Lid

The extendable hinge on the V39II enables you to scan documents up to 6 mm thick with the lid closed. And for thicker items such as books and photo albums, simply remove the lid.



### Easy Operational Workflow and Versatile Media Options

#### Epson ScanSmart

Epson ScanSmart with simplified user interface and features allow users to have a seamless and hassle-free scanning experience.



#### Simple Operation

Review, rearrange and rotate pages right after scanning and save it to a file.

#### Automatic Scan Mode Detection

Automatically detect the type of originals for the right editing enhancement functions when scanning documents or photos.

#### Versatile Output Capability

Attach scanned images to email or send the files directly to popular cloud storage services.

#### Built-in Character Recognition

Create searchable PDF which allows users to locate their documents easily by searching for keywords.

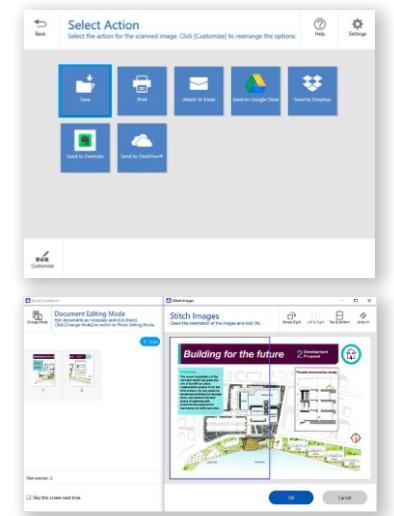

#### Stitch Image

Stitch images together when scanning a document larger than the document glass.

#### Optional Flatbed Dock

A Flatbed Dock can be used to integrate the V39II with compatible sheet-fed document scanner. Users can have the option to scan thick objects such as books, or small and fragile documents that can be easily damaged such as receipts.

Compatible sheet-fed document scanner models: DS-530II, DS-770II, DS-870, DS-970.

\*Push scanning is not supported for Flatbed. For Mac, installation of the V39II scanner driver is required.



### Zero Warm-up Time, Eco-friendly Feature

With Epson's ReadyScan LED Technology, the V39II starts scanning instantly with no warm-up time required. Featuring a mercury-free LED light source, this eco-friendly scanner is low in heat dissipation and power consumption, allowing you to be energy-efficient and cost effective.

